



# QUICKDRAIN SQUAREDRAIN DRAIN BODIES TECHNICAL SPECIFICATION

## DESCRIPTION

The SquareDrain drain bodies are made of 18 gauge 304 stainless steel. They are available in three sizes; 4", 5" and 6", and in multiple finish options including Brushed Gold, Brushed Stainless Steel, Matte Black, Oil Rubbed Bronze, and Polished Rose Gold, Polished Stainless Steel. The drain capacity for the 2" outlet shall be 10 GPM in a shower pan with curb.

## APPLICATIONS/USES

- Industrial, commercial and residential showers
- Gang showers
- Pet Showers

## SUITABLE SUBSTRATES (INTERIOR ONLY)

- Concrete
- Exterior glue plywood
- Cement backer board\*\*
- OSB or Avantech

\*\*Consult cement backer board manufacturer for specific installation recommendations

## DRAIN ASSEMBLY INCLUDES

304 Stainless Steel Drain Body, 2" Threaded Outlet Adaptor with O-ring, Cover Removal Key and Debris Basket.

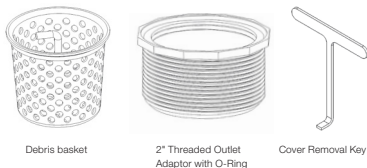

## REQUIRED PART (NOT INCLUDED)

304 SS Drain Cover is not included and is required for assembly. Please see SquareDrain Covers Technical Specification for finishes and designs.

## OPTIONAL ACCESSORIES:

### Drains & Flanges

- Oatey 130-Series Drain
- Universal Flange Adaptor Kits for new construction and renovations

### Shower Pan Accessories:

- Pre-sloped PET Pans and Curbs

### Waterproofing Accessories

- Preformed Corners and Curb Covers for topical liquid, Topical Sheet Fabric & Accessories, Oatey® PVC/CPE Liner and X-15 Adhesive

Job Name _____	Item # _____
Location _____	
Engineer _____	Contractor _____
PO # _____	Tag _____
Representative _____	

## APPROVALS AND LISTINGS

Before installing QuickDrain USA system, check with your local building department/plumbing inspector to ensure compliance with the local building codes. QuickDrain USA LLC is not responsible for any conflicts with local building codes. QuickDrain USA LLC is not responsible for improper installation of any part of the assembly or the waterproofing membrane. Dimensions are subject to manufacturer's tolerance and can change without notice.

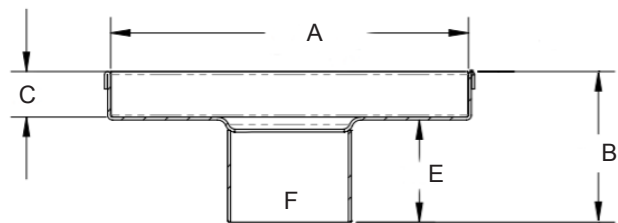
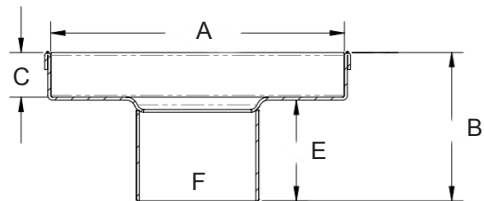
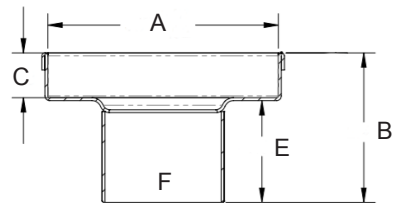
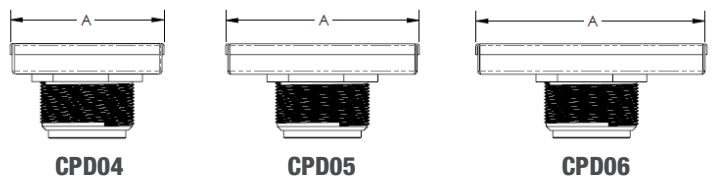

## DIMENSIONS

[A]:	Width:	4", 5", 6"	[E]:	Hub Height	1.65"
[B]:	Height:	2.43"	[F]:	Hub Diameter (OD)	2"
[C]:	Depth	0.73"	[G]:	Material Thickness	18GA

Access BIM/Revit content through [www.oatey.com](http://www.oatey.com)



## QUICKDRAIN SQUAREDRAIN DRAIN BODIES TECHNICAL SPECIFICATION

### PRODUCT SELECTOR

✓	PRODUCT NUMBER	DESCRIPTION	FINISH
<b>DRAIN BODY ONLY</b>			
	CPD04	4" Drain Body	Brushed Stainless Steel
	CPD04-BG	4" Drain Body	Brushed Gold
	CPD04-MB	4" Drain Body	Matte Black
	CPD04-ORB	4" Drain Body	Oil Rubbed Bronze
	CPD04-PRG	4" Drain Body	Polished Rose Gold
	CPD05	5" Drain Body	Brushed Stainless Steel
	CPD05-BG	5" Drain Body	Brushed Gold
	CPD05-MB	5" Drain Body	Matte Black
	CPD05-ORB	5" Drain Body	Oil Rubbed Bronze
	CPD05-PRG	5" Drain Body	Polished Rose Gold
	CPD06	6" Drain Body	Brushed Stainless Steel
	CPD06-BG	6" Drain Body	Brushed Gold
	CPD06-MB	6" Drain Body	Matte Black
	CPD06-ORB	6" Drain Body	Oil Rubbed Bronze
	CPD06-PRG	6" Drain Body	Polished Rose Gold

### SQUAREDRAIN VERTICAL WASTE OUTLET WITH PET POINT PAN AND SHEET WATERPROOFING

1. Stud Wall
2. Wall Board
3. Sheet Wall Waterproofing
4. Thinset (for wall tile)
5. Wall Tile and Grout
6. Thinset
7. Sheet Shower Pan Waterproofing
8. Counter-sloped PET Foam Point Pan
9. Thinset
10. Subfloor
11. Universal Flange Adaptor
12. Weep Guard
13. SquareDrain Drain Body
14. SquareDrain Cover
15. PET Foam Curb
16. Curb Cover

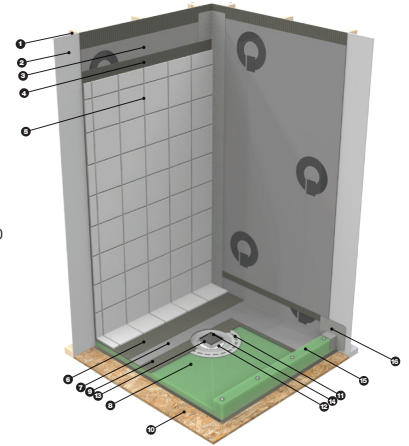

### SQUAREDRAIN VERTICAL WASTE OUTLET WITH REINFORCED CONCRETE SLOPE AND SHEET WATERPROOFING

1. Stud Wall
2. Wall Board
3. Sheet Wall Waterproofing
4. Thinset (for wall tile)
5. Wall Tile and Grout
6. Thinset
7. Sheet Shower Pan Waterproofing
8. Reinforced Concrete Slope
9. Thinset
10. Subfloor
11. Universal Flange Adaptor
12. Weep Guard
13. SquareDrain Drain Body
14. SquareDrain Cover
15. PET Foam Curb
16. Curb Cover

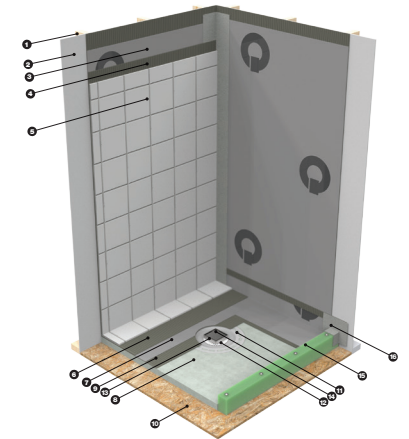

### SQUAREDRAIN VERTICAL WASTE OUTLET WITH PET POINT PAN AND SHEET WATERPROOFING FOR CURBLESS AND ADA SHOWERS

1. Stud Wall
2. Wall Board
3. Sheet Wall Waterproofing
4. Thinset (for wall tile)
5. Wall Tile and Grout
6. Thinset
7. Sheet Shower Pan Waterproofing
8. Counter-sloped PET Foam Point Pan
9. Thinset
10. Subfloor
11. Universal Flange Adaptor
12. Weep Guard
13. SquareDrain Drain Body
14. SquareDrain Cover
15. Wall Board / Underlayment
16. Outside Corner

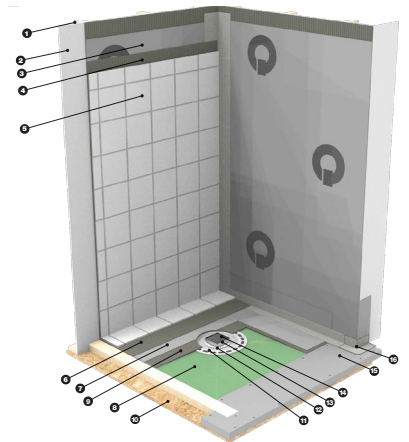

Access BIM/Revit content through [www.oatey.com](http://www.oatey.com)