



## CMDB CUSTOM FABRICATED PROLINE DRAIN BODY TECHNICAL SPECIFICATION

### DESCRIPTION

- 18 Gauge 316L Stainless Steel.
- Key feature of the drain body is a fully-sloped trough that prevents standing water and solids being deposited into the trough.
- 2" or 1.5" I.D. schedule 10 stainless steel waste outlet.
- Waste outlets may be placed at nearly any location.
- Length adjustability of drain trough with use of trough extensions. QuickDrain USA recommends the drain cover extend the entire length of the shower pan (wall to wall or wall to curb).
- Height adjustability of drain cover with use of spacers for different thicknesses of finished material from 3/8" to 3/4". Custom spacers are available for finished material thicknesses from 1"-2 1/2".
- A signed QuickDrain drawing and purchase order are required to start fabrication on all custom drains.
- A lead time will apply to all custom items.

### DRAIN BODY INCLUDES

- Height Adjustable Spacers\*
- Trough Extensions (2)
- Two Band Coupling\*\*
- Cover Removal Key (2)
- Transition Tape\*
- Inside Corners (4)
- Outside Corners (2)
- Reinforcement Tape (1)

\*\*Quantity TBD

### OPTIONAL ACCESSORIES

- Drain Accessories: Leveling or Placement Brackets (2)
- Shower Pan Accessories: Quick Slopes, Flat Panels, Curb Forms
- Liquid Waterproofing Accessories: Curb Covers

### REQUIRED PART (NOT INCLUDED) – DRAIN COVER

- Available in the designs below and in these lengths – 18", 32", 40", 48", 56", 64", and 72".
- Custom long lengths are an option in the COSMO and VERTICAL designs - 72"-120".
- Resinous drain covers are an option in the COSMO design – 26.5"-100.5".

Job Name _____	Item # _____
Location _____	
Engineer _____	Contractor _____
PO # _____	Tag _____
Representative _____	



ITEM CODE	DESCRIPTION
PLD10 to PLD100 (CMDB)	<b>Non-Standard Size</b> Custom drains made in any size increment between 10"-100" Long. Maximum size with one waste outlet is 68" total length not including the flanges. Drains longer than 68" must have two waste outlets per trough due to the depth, length and internal pitch of the trough.
PLD10 to PLD100 (CMDB)	<b>Commercial Waste Outlet</b> Commercial facilities have special requirements. To meet fireproofing codes, waste outlets can be made in custom lengths from 2" to 14" below the trough. Longer pipes allow waste lines to go through concrete floor so the plumbing connection is done below fireproofing.
PLD10 to PLD100 (CMDB)	<b>Side Waste Outlet</b> Primarily used in retrofitting situations when there are limitations on space and location of existing floors and outlets. The side waste outlet drops and turns 90 degrees and is only 2 9/16" deep, eliminating the need to drill through concrete.
PLD10 to PLD100 (CMDB)	<b>Resinous Drain</b> These drains are suitable for epoxy flooring, urethane and sheet vinyl flooring, making them ideal for commercial use. The trough is surrounded by a 3 1/16" square stainless steel frame. <b>Resinous drain cover required.</b>
PLD10 to PLD100 (CMDB)	<b>Multiple Outlets</b> Water flow output of more than 10 gallons per minute can be addressed with additional outlets on the drain body. QuickDrain waste outlets can accommodate this increased flow. While the appearance is similar to a standard drain, these solutions can double or triple water flow capacity.

Access BIM/Revit content through [www.LRBrands.com/QuickDrain](http://www.LRBrands.com/QuickDrain)



## CMDB CUSTOM FABRICATED PROLINE DRAIN BODY TECHNICAL SPECIFICATION

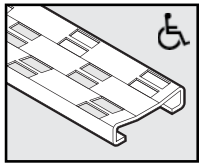

**Cosmo**

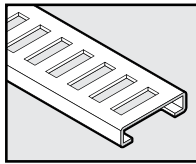

**Vertical\***

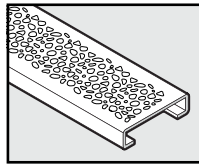

**Stones**

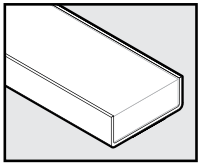

**Tilein\***

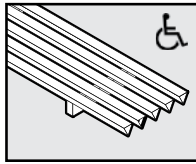

**Lines**

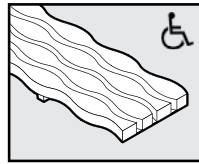

**Stream**

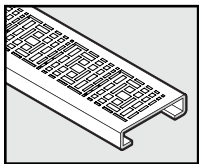

**Deco**

### CUSTOM DRAIN DIMENSIONS

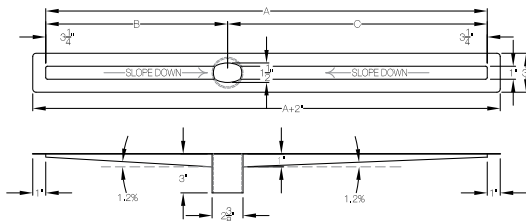

### RESINOUS DRAIN DIMENSIONS

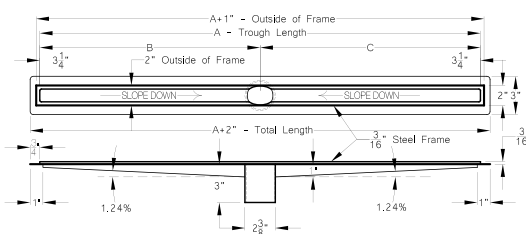

### SIDE WASTE OUTLET DIMENSIONS

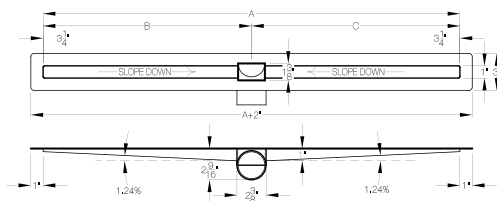

### PROLINE DRAIN ASSEMBLY

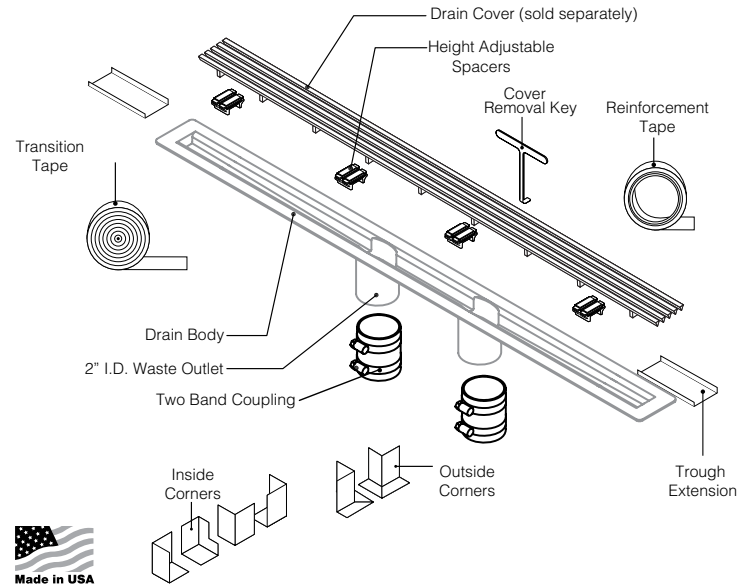

**Note:** We will no longer include the cap screw tabs on the drain unless otherwise noted from the customer that they will be needed. Please let us know at time of order.

### MULTIPLE OUTLET DIMENSIONS

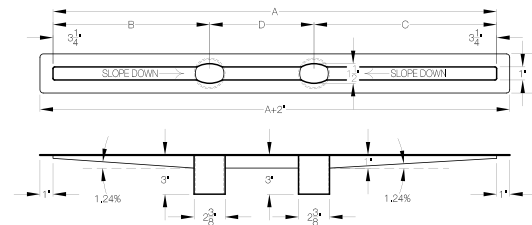

### COMMERCIAL WASTE OUTLET DIMENSIONS

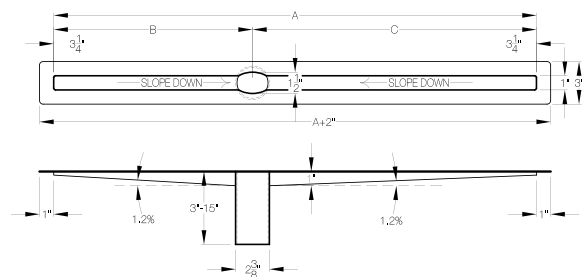

Access BIM/Revit content through [www.LRBrands.com/QuickDrain](http://www.LRBrands.com/QuickDrain)



## CMDB CUSTOM FABRICATED PROLINE DRAIN BODY TECHNICAL SPECIFICATION

### INSTALLATION NOTES

- Install product according to the appropriate ProLine Drain Installation details.
- Drain body cannot be cut to size or modified on site.
- Drain cover may be cut on site to finished length.
- When used at the entry to a curbless shower as a primary shower drain, the capacity of one outlet is 5 GPM and COSMO, LINES, or STREAM are the only recommended cover patterns.

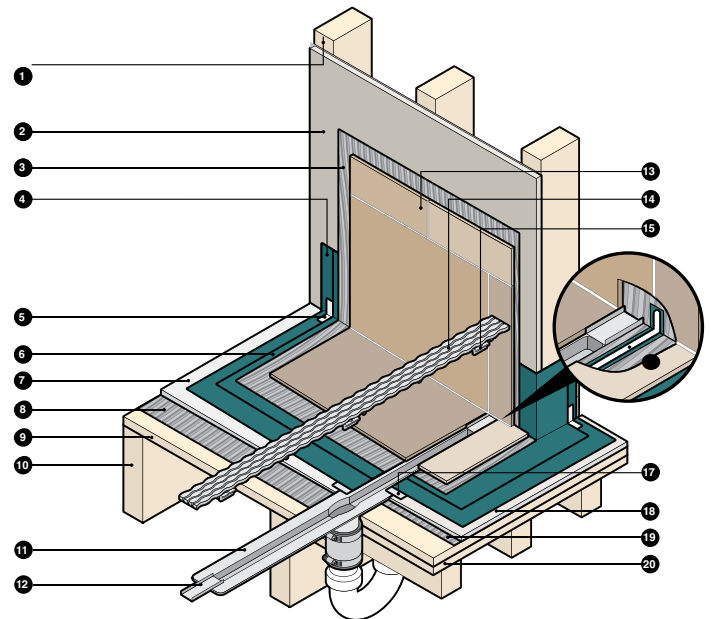

- |    |                                      |    |                                 |
|----|--------------------------------------|----|---------------------------------|
| 1  | Stud Wall                            | 11 | Drain Body                      |
| 2  | Backer Board                         | 12 | Trough Extension                |
| 3  | Thin-set (for wall tile)             | 13 | Wall Tile and Grout             |
| 4  | First layer of Liquid Waterproofing  | 14 | Drain Cover                     |
| 5  | Reinforcing Fabric                   | 15 | Height Adjustable Spacer        |
| 6  | Second layer of Liquid Waterproofing | 16 | Capillary Break                 |
| 7  | Quick Slope                          | 17 | Transition Tape                 |
| 8  | Thin-set                             | 18 | De-coupling Crack-isolation Mat |
| 9  | Sub-floor                            | 19 | Thin-set                        |
| 10 | Floor Joists (wood floor)            | 20 | Blocking(wood floor)            |